

# POWDER SIEVING

---

**VIBRO SIFTER - GMP MODEL**



## **SALIENT FEATURES**

- Most suitable for sieving of drawing powders and Granules.
- Gyrotory Vibro Sifter is being designed for continuous operation.
- Available in various models of screen diameter, ranging from 12" to 72" Screen Diameter.
- Portable, Noiseless, Compact and maintenance free unit, with higher output capacity.
- Electrical power requirement is less than other machine of the same kind in the industries and conventional reciprocating type Vibratory Sifter.
- Stainless Steel 316 grade contact parts with option for different MOC for contact parts.
- All contact parts can be easily and quickly dismantled and cleaned.



## **GENERAL SPECIFICATIONS**

<b>SERVICE</b>	Sieving of dry granules and Powders.
<b>DUTY</b>	Continuous type
<b>MOUNTING</b>	Vertical on Base with wheels
<b>LOCATION</b>	Inside the room
<b>MODEL</b>	Available in Lab Scale, Regular commercial scale and Higher Output Models.
<b>CAPACITY</b>	Output and quality of Final product depends upon, Feed Size, Screen Size and product properties.

## **OPERATING & DESIGN CONDITIONS**

<b>FEED MATERIALS</b>	Dry powder / Granules
<b>BULK DENSITY</b>	0.6 gms /cc
<b>OPERATING TEMPERATURE</b>	AMB
<b>OPERATING PRESSURE</b>	ATM

## **DRIVE MECHANISM**

<b>POWER REQUIREMENT</b>	3Ph/415VAC/50 Hz/AC
<b>DRIVE MOTOR HP</b>	*** HP / 1440 RPM / NON FLP
<b>CHARGING PORT SIZE</b>	***
<b>DISCHARGING PORT SIZE</b>	***
<b>OVERSIZE DISCHARGE PORT SIZE</b>	***

## **APPLICATION**

- Sieving of Dry Powders and granules in Pharmaceutical Tablet Granulation, API & Bulk Drug Manufacturing, Food Industries, Speciality chemical Industries and all powder processing Industries.

## **OPTIONS**

- Options available for double, triple and four deck unit.
- Flame proof drive motor with flame proof operating Panel.
- Anti-Static rubber gasket with Anti-Static PU coated wheels.
- Special requirement like magnetic grill at inlet / outlet, anti-screen chocking arrangement, guide chute for subsequent deck etc...
- Stainless Steel 316L, Stainless Steel 304 or 304 L grade contact parts.
- Tailor made construction.
- Combo Unit with Multi Mill at charging port.
- Center discharge model available on request.

## **DOCUMENTS**

Following Documents will be provided

- Final Design Specifications with Design Qualification Documents
- General Arrangement drawing
- Final as Built Drawing
- Factory Acceptance Test Protocol
- Installation Qualification Documents
- Operational Qualification Documents
- Performance Qualification Documents
- Electrical Wiring Diagram
- Raw Material Test Certificate for contact parts
- Bought Out Item Test Certificate
- Warranty Certificate
- Site Acceptance Test protocol
- Surface roughness report

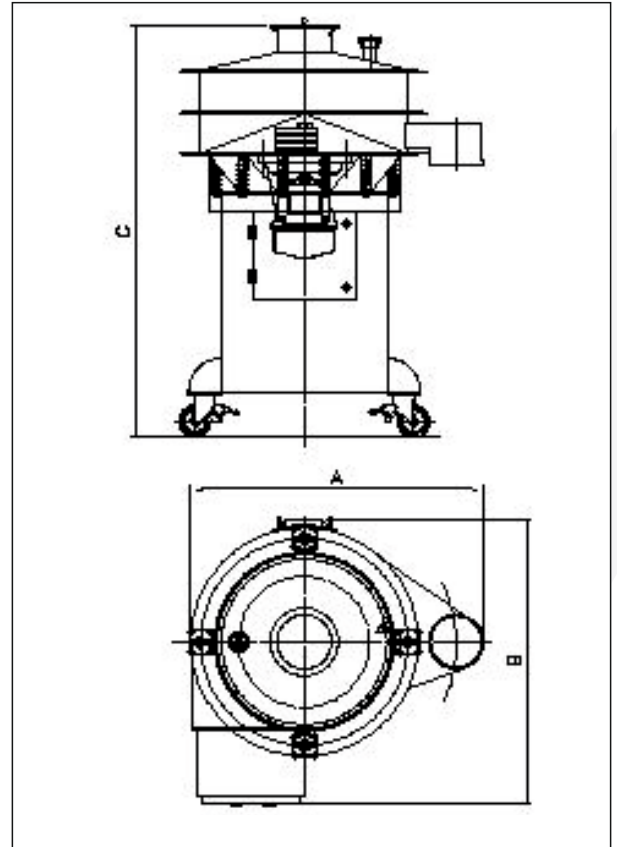

## **TECHNICAL SPECIFICATIONS**

MODEL	OUTPUT	MOTOR H.P.	A	B	C
SES-VSS-12	Up to 25 kg/Hr.	0.25	450	325	900
SES-VSS-20	Up to 100 kg/Hr.	0.50	650	525	1100
SES-VSS-24	Up to 150 kg/Hr.	0.50	750	625	1200
SES-VSS-30	Up to 200 kg/Hr.	0.50	925	800	1250
SES-VSS-36	Up to 300 kg/Hr.	1.0	1100	950	1350
SES-VSS-48	Up to 500 kg/Hr.	1.5	1375	1250	1400
SES-VSS-60	Up to 1000 kg/Hr.	3.0	1750	1600	1600
SES-VSS-72	Up to 1500 kg/Hr.	5.0	2100	1900	1750

**Note :** Output is depending on product properties, input feed size and mesh size.



**Shree Engineering Service is an engineering company active  
in providing wide range of industry verticals.**

📍 B/202, Dev Ashish Sankalp, Naroda -  
Dehgam Road, Near S.P. Ring Road,  
Naroda, Ahmedabad - 382330 GJ.

✉ info@shreeengineeringservice.com  
shreeengineeringservice3@gmail.com  
☎ 98252 58722 / 93761 58722

[www.shreeengineeringservice.com](http://www.shreeengineeringservice.com)

[www.powderblender.co.in](http://www.powderblender.co.in) | [www.inlinehomogenizer.co.in](http://www.inlinehomogenizer.co.in)