

# FEMALE BRANCH TEE

## INCH OD Tubes x Female NPT Threads



T Tube OD	P NPT Female	A	Ax	B	C	D	E min.	F A/F	G A/F	H	Hx	Hy	FITEXCEL PART NO.
1/8	1/8	49.2	24.6	10.4	15.3	12.7	2.4	14	11	36.0	18.0	19.0	FFBT-417-N
1/4	1/8	53.8	26.9	10.4	17.8	15.3	4.8	14	14	39.2	19.6	19.0	FFBT-418-N
1/4	1/4	59.4	27.9	15.0	17.8	15.3	4.8	19	14	44.8	22.4	22.4	FFBT-419-N
3/8	1/4	62.4	31.2	15.0	19.3	16.8	7.1	16	16	47.8	23.9	22.4	FFBT-420-N
3/8	3/8	66.6	33.3	15.0	19.3	16.8	7.1	19	16	51.8	25.9	22.4	FFBT-421-N
1/2	3/8	72.0	36.0	15.0	21.8	22.9	10.4	19	19	51.8	25.9	22.4	FFBT-422-N
1/2	1/2	77.8	38.9	19.8	21.8	22.9	10.4	22	22	57.4	28.7	28.5	FFBT-423-N
3/4	3/4	89.4	44.7	20.6	21.8	24.4	15.8	35	22	69.2	34.6	31.8	FFBT-424-N
1	3/4	98.0	49.0	20.6	26.4	31.2	22.3	35	25	73.6	36.8	31.8	FFBT-425-N
1	1	107.2	53.6	25.4	26.4	31.2	22.3	41	38	82.8	41.4	38.1	FFBT-426-N

## METRIC OD Tubes x Female NPT Threads

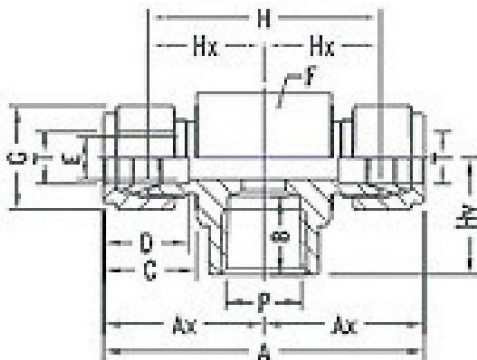

T Tube OD	P NPT Female	A	Ax	B	C	D	E min.	F A/F	G A/F	H	Hx	Hy	FITEXCEL PART NO.
3	1/8	49.2	24.6	10.4	15.3	12.9	2.4	14	11	36.0	18.0	19.0	FFBT-427-N
6	1/8	54.0	27.0	10.4	17.7	15.3	4.8	14	14	39.2	19.6	19.0	FFBT-428-N
6	1/4	59.6	29.8	15.0	17.7	15.3	4.8	19	14	44.8	22.4	22.4	FFBT-429-N
8	1/8	59.8	29.9	10.4	18.6	16.2	6.3	16	16	44.8	22.4	19.0	FFBT-430-N
8	1/4	61.2	30.6	15.0	18.6	16.2	6.3	19	16	46.2	23.1	22.4	FFBT-431-N
10	1/4	67.0	33.5	15.0	19.5	17.2	7.9	19	19	51.8	25.9	22.4	FFBT-432-N
12	3/8	72.0	36.0	15.0	22.0	22.8	9.5	22	22	51.8	25.9	22.4	FFBT-433-N
12	1/2	77.6	38.8	19.8	22.0	22.8	9.5	27	22	57.4	28.7	28.5	FFBT-434-N
16	1/2	79.0	39.5	19.8	22.0	24.4	12.7	27	25	59.4	29.7	28.5	FFBT-435-N